

## HOME TRAINING IN CABINET WORK

### A LOW TABLE

**T**HE simple, substantial table shown here corresponds somewhat with the piano bench in design. The solid ends are sloped out at the bottom in a very sturdy structural effect, the severity of which is relieved by the curve seen at the bottom. This curved line is repeated in the brace that supports the top and holds the ends together. This brace and the lower shelf are fastened with tenons that project slightly and add an ornamental touch to the plain ends.

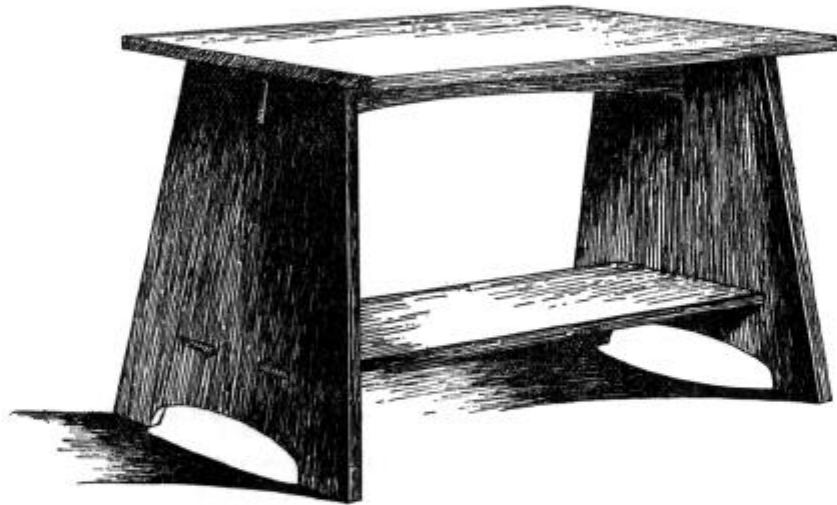

MILL BILL OF STOCK FOR TABLE.

Pieces.	No.	Rough			Finish	
		Long	Wide	Thick	Wide	Thick
Top .....	1	42½ in.	24½ in.	1⅛ in.	24 in.	1 in.
Sides .....	2	29½ in.	24½ in.	1½ in.	pattern	1¼ in.
Shelves .....	1	41½ in.	14¼ in.	1 in.	14 in.	⅞ in.
Stretchers .....	1	38½ in.	4¼ in.	1½ in.	pattern	1¼ in.
Top braces .....	2	20 in.	2 in.	⅞ in.	1¾ in.	¾ in.

# HOME TRAINING IN CABINET WORK

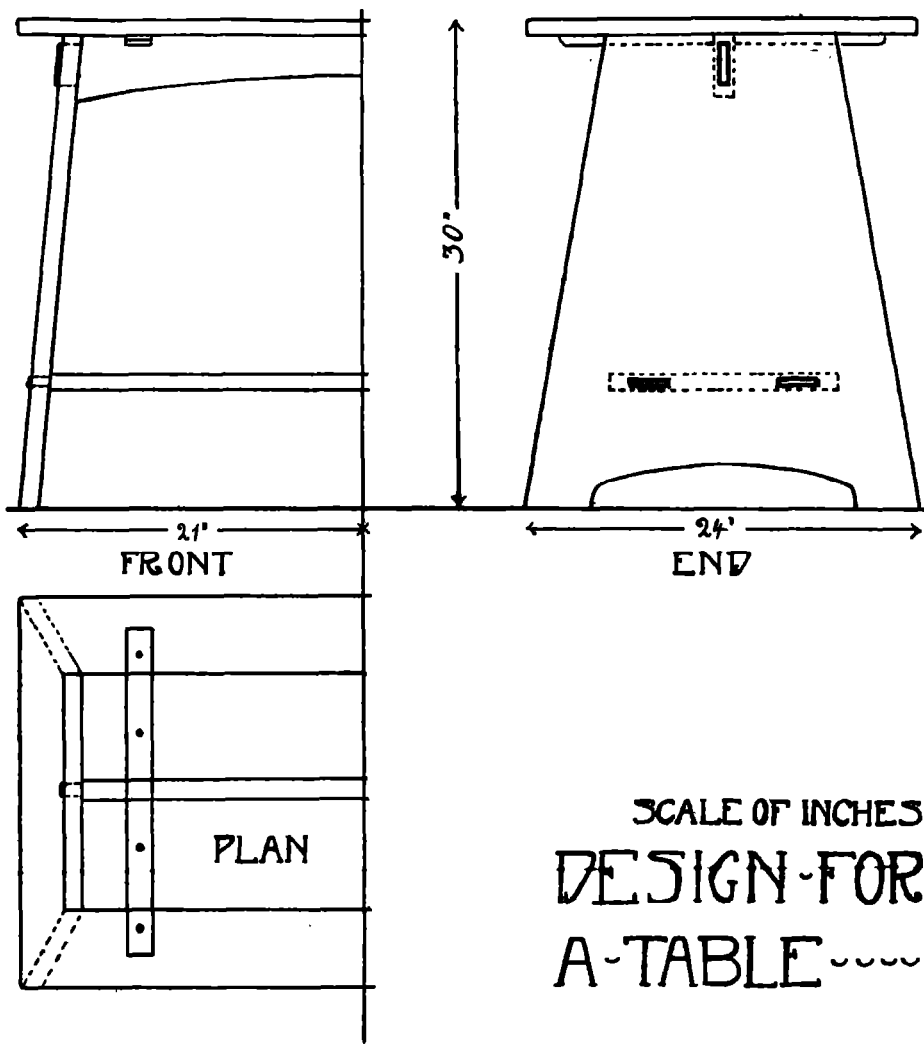

SCALE OF INCHES  
DESIGN FOR  
A TABLE

## HOME TRAINING IN CABINET WORK

### CABINET FOR PIANOLA RECORDS

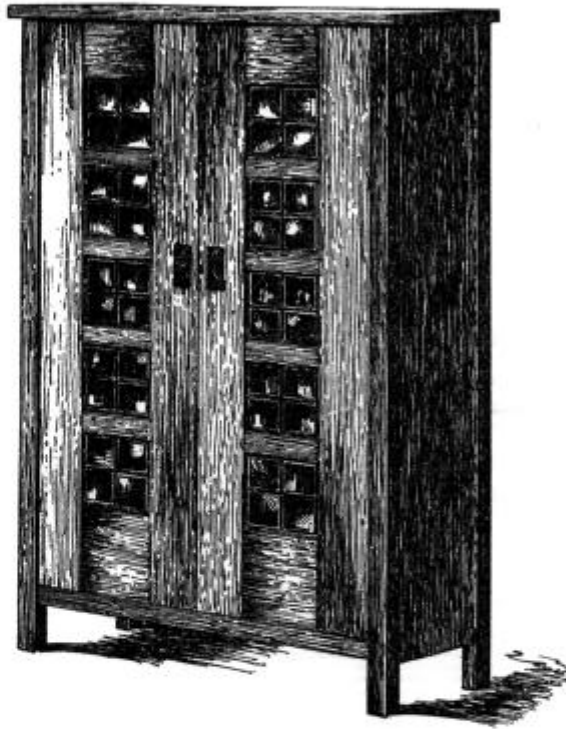

SO MANY pianos now have the Pianola attachment that a place for keeping the records has become a necessity in many homes. This cabinet can easily be made at home, and should prove an interesting design to the amateur cabinetmaker. The construction is very plain, and, aside from its proportions, most of the beauty of the piece will depend upon the selection and finish of the wood and upon careful workmanship. The small panes of leaded glass in the doors are decorative in themselves, and the only touch of ornament is seen in the decorative quality of the door-pulls of hand-wrought metal, which may be of brass, copper or iron, according to the finish selected for the piece. The inside of the cabinet is furnished with shelves.

#### MILL BILL OF STOCK FOR PIANOLA RECORD CABINET.

Pieces.	No.	Rough			Finish		
		Long	Wide	Thick	Wide	Thick	
Top .....	1	33½ in.	17 in.	1 in.	16¾ in.	7/8 in.	
Posts .....	4	48½ in.	1¾ in.	1¾ in.	1½ in.	1½ in.	
Bottom .....	1	29½ in.	15¼ in.	5/8 in.	15 in.	½ in.	
Sides .....	2	45½ in.	14 in.	7/8 in.	13¾ in.	¾ in.	
Back stiles .....	2	45 in.	3¼ in.	5/8 in.	3 in.	½ in.	
Back rails .....	2	29½ in.	5¼ in.	5/8 in.	5 in.	½ in.	
Back panel .....	1	36 in.	24 in.	½ in.	23½ in.	3/8 in.	
Door stiles .....	4	44 in.	4½ in.	7/8 in.	4 in.	¾ in.	

# HOME TRAINING IN CABINET WORK

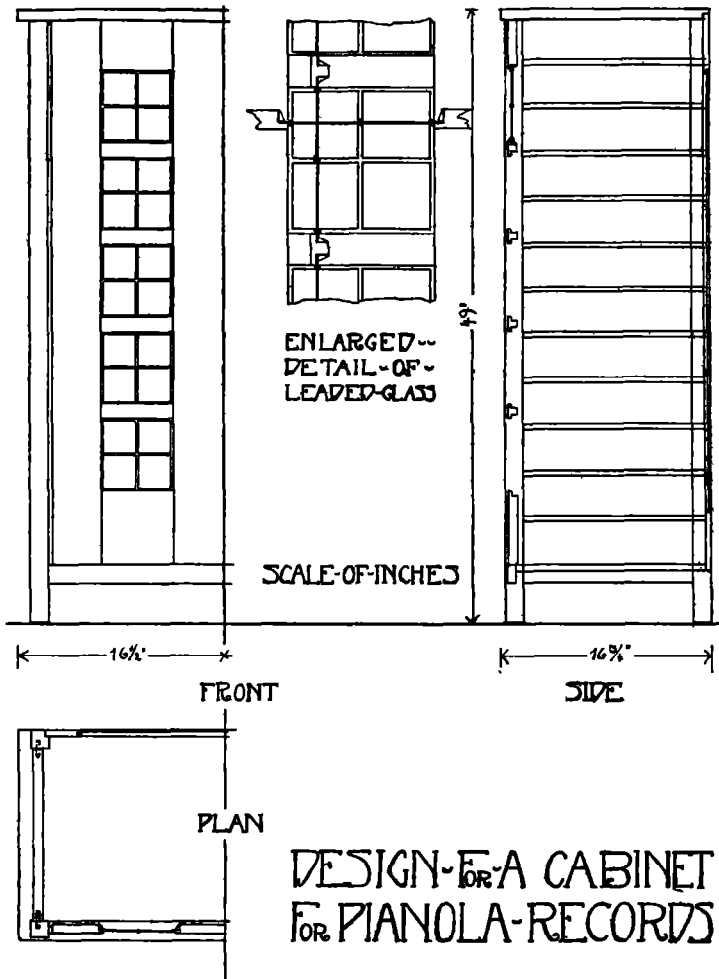

Door rails	2	12 in.	6 $\frac{1}{4}$ in.	$\frac{7}{8}$ in.	6 in.	$\frac{3}{4}$ in.
Door rails	2	12 in.	9 $\frac{1}{4}$ in.	$\frac{7}{8}$ in.	9 in.	$\frac{3}{4}$ in.
Door rails	8	8 in.	1 $\frac{1}{2}$ in.	$\frac{7}{8}$ in.	11 $\frac{1}{4}$ in.	$\frac{3}{4}$ in.
Door stops	2	44 in.	1 $\frac{1}{2}$ in.	$\frac{7}{8}$ in.	11 $\frac{1}{4}$ in.	$\frac{3}{4}$ in.
Shelves	11	29 $\frac{1}{2}$ in.	15 in.	$\frac{1}{2}$ in.	14 $\frac{5}{8}$ in.	$\frac{3}{8}$ in.
Front stretcher	1	30 in.	1 $\frac{3}{4}$ in.	$\frac{3}{4}$ in.	11 $\frac{1}{2}$ in.	$\frac{5}{8}$ in.
Leaded glass	10	6 $\frac{1}{2}$ in.	6 $\frac{1}{2}$ in.			
Size of openings		5 $\frac{3}{4}$ in.	5 $\frac{3}{4}$ in.			